

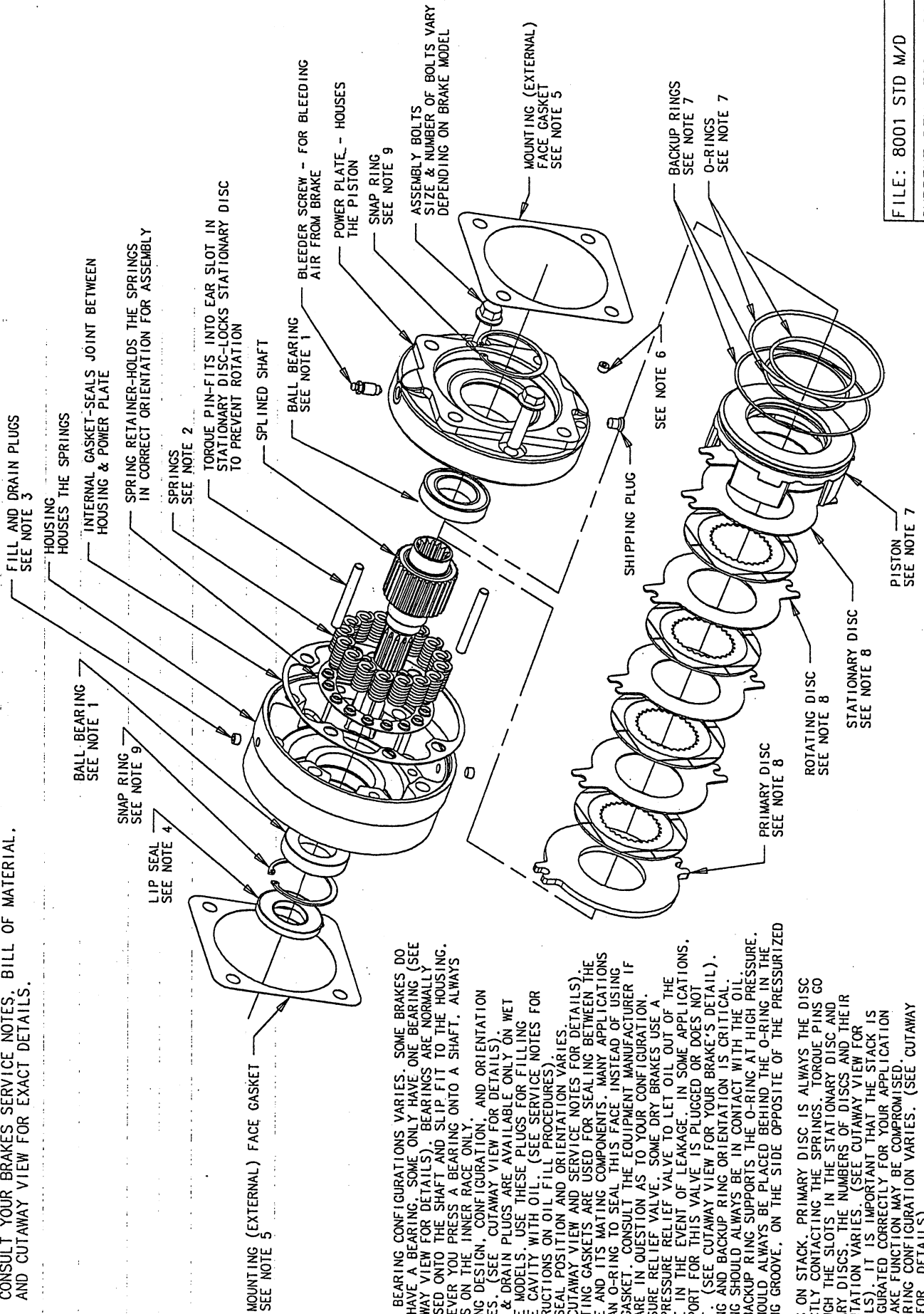

STANDARD WET OR DRY MULTI-DISC BRAKES GENERAL ASSEMBLY VIEW

NOTE: THIS DRAWING PROVIDES GENERAL GUIDELINES AND ASSEMBLY INFORMATION ON AUSCO MULTI-DISC BRAKES. CONFIGURATION OF BRAKES VARIES FROM MODEL TO MODEL. CONSULT YOUR BRAKES SERVICE NOTES, BILL OF MATERIAL, AND CUTAWAY VIEW FOR EXACT DETAILS.



- NOTES:
1. BALL BEARING CONFIGURATIONS VARIES. SOME BRAKES DO NOT HAVE A BEARING. SOME ONLY HAVE ONE BEARING (SEE CUTAWAY VIEW FOR DETAILS). BEARINGS ARE NORMALLY PRESSED ONTO THE SHAFT AND SLIP FIT TO THE HOUSING. WHENEVER YOU PRESS A BEARING ONTO A SHAFT, ALWAYS PRESS ON THE INNER RACE ONLY.
 2. SPRING DESIGN, CONFIGURATION, AND ORIENTATION VARIES (SEE CUTAWAY VIEW FOR DETAILS).
 3. FILL & DRAIN PLUGS ARE AVAILABLE ONLY ON WET BRAKE MODELS. USE THESE PLUGS FOR FILLING BRAKE CAVITY WITH OIL. (SEE SERVICE NOTES FOR INSTRUCTIONS ON OIL FILL PROCEDURES)
 4. LIP SEAL POSITION AND ORIENTATION VARIES (SEE CUTAWAY VIEW AND SERVICE NOTES FOR DETAILS).
 5. MOUNTING GASKETS ARE USED FOR SEALING BETWEEN THE BRAKE AND ITS MATING COMPONENTS. MANY APPLICATIONS USE AN O-RING TO SEAL THIS FACE INSTEAD OF USING THE GASKET. CONSULT THE EQUIPMENT MANUFACTURER IF YOU ARE IN QUESTION AS TO YOUR CONFIGURATION.
 6. PRESSURE RELIEF VALVE. SOME DRY BRAKES USE A LOW PRESSURE RELIEF VALVE TO LET OIL OUT OF THE BRAKE IN THE EVENT OF LEAKAGE. IN SOME APPLICATIONS, THE PORT FOR THIS VALVE IS PLUGGED OR DOES NOT EXIST. (SEE CUTAWAY VIEW FOR YOUR BRAKE'S DETAIL).
 7. O-RING AND BACKUP RING ORIENTATION IS CRITICAL. O-RING SHOULD ALWAYS BE IN CONTACT WITH THE OIL. THE BACKUP RING SUPPORTS THE O-RING AT HIGH PRESSURE. IT SHOULD ALWAYS BE PLACED BEHIND THE O-RING IN THE O-RING GROOVE, ON THE SIDE OPPOSITE OF THE PRESSURIZED OIL.
 8. NOTES ON STACK. PRIMARY DISC IS ALWAYS THE DISC DIRECTLY CONTACTING THE SPRINGS. TORQUE PINS GO THROUGH THE SLOTS IN THE STATIONARY DISC AND PRIMARY DISCS. THE NUMBERS OF DISCS AND THEIR ORIENTATION VARIES (SEE CUTAWAY VIEW FOR DETAILS). IT IS IMPORTANT THAT THE STACK IS CONFIGURED CORRECTLY FOR YOUR APPLICATION OR BRAKE FUNCTION MAY BE COMPROMISED.
 9. SNAP RING CONFIGURATION VARIES. (SEE CUTAWAY VIEW FOR DETAILS).

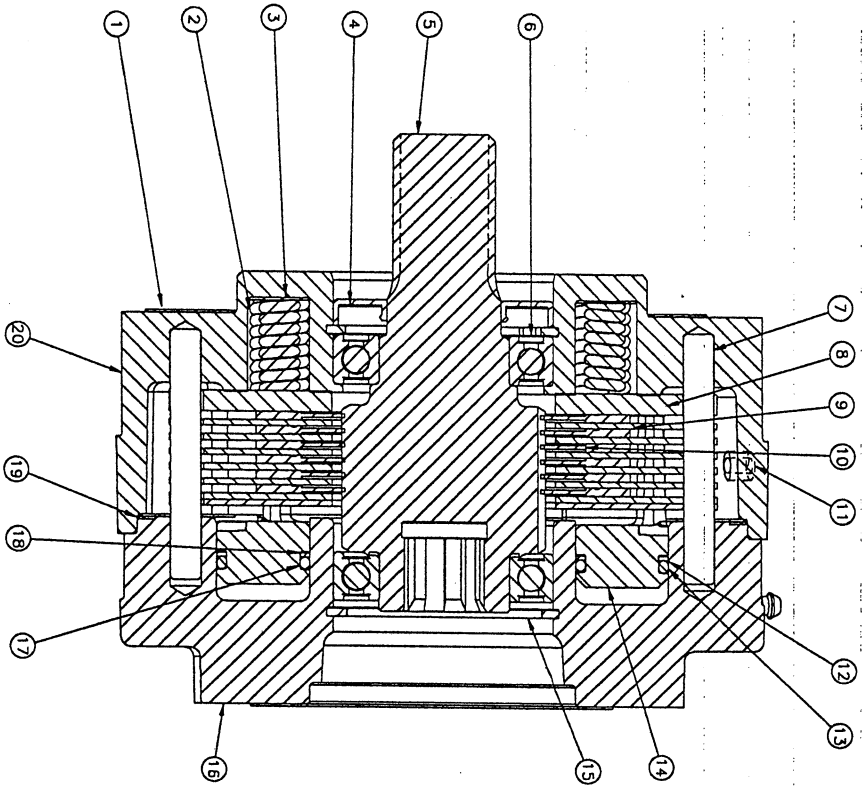

SECTION A-A

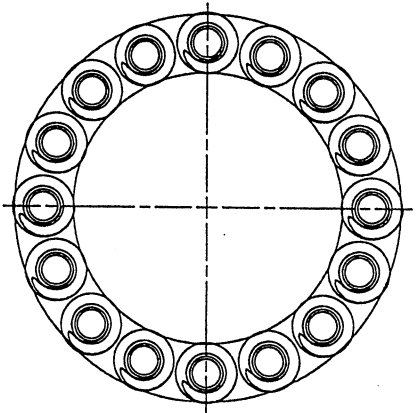
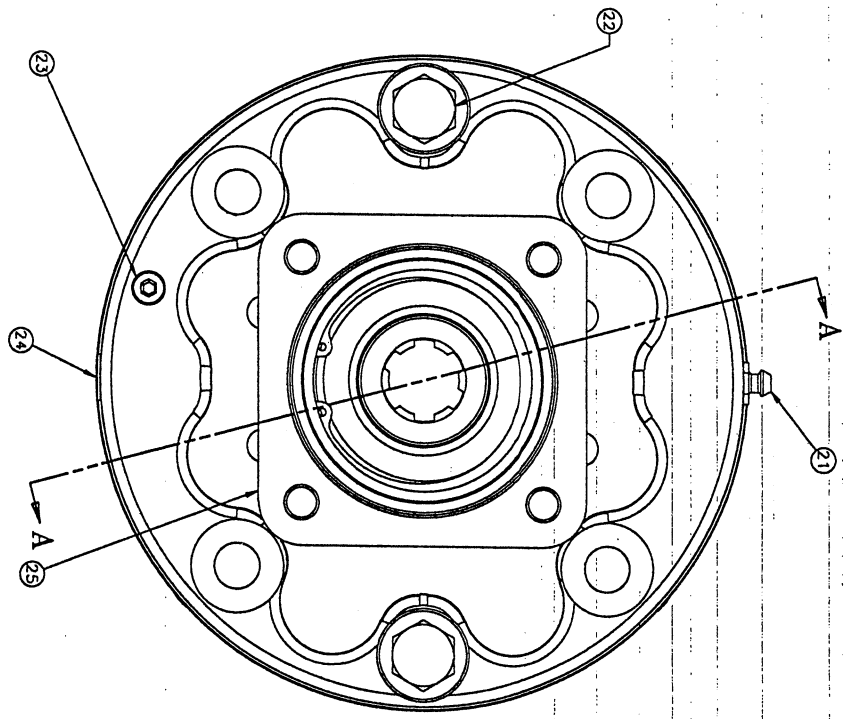

NESTED SPRING ORIENTATION

BRAKE NUMBER 78299 PARTS LIST

EC011724 REV C

ITEM	PART	DESCRIPTION	QTY
1	28427	GASKET	1
2	36359	COMPRESSION SPRINGS	16
3	36367	SPRING RETAINER	1
4	36342	LIP SEAL	1
5	78298	SPLINED SHAFT	1
6	28284	BALL BEARING	2
7	27948	TORQUE PIN	2
8	75071	PRIMARY DISC	1
9	75072	STATIONARY DISC	7
10	74996	ROTATING DISC	6
11	75395	TEFLON TAPERED PLUG	2
12	32833	BACKUP RING	1
13	36701	O-RING	1
14	75724	PISTON	1
15	28285	RETAINING RING	2
16	37323	POWER PLATE	1
17	27808	O-RING	1
18	27967	BACKUP RING	1
19	73448	GASKET	1
20	75731	HOUSING	1
21	29035	BLEEDER SCREW	1
22	31218	FLANGE HEX SCREW	2
23	28811	HEX PLUG	1
24	28435	PROTECTIVE PLUG	1
25	30468	GASKET	1