

# Modified SAE 'A' to SAE 'C' Mount – WET

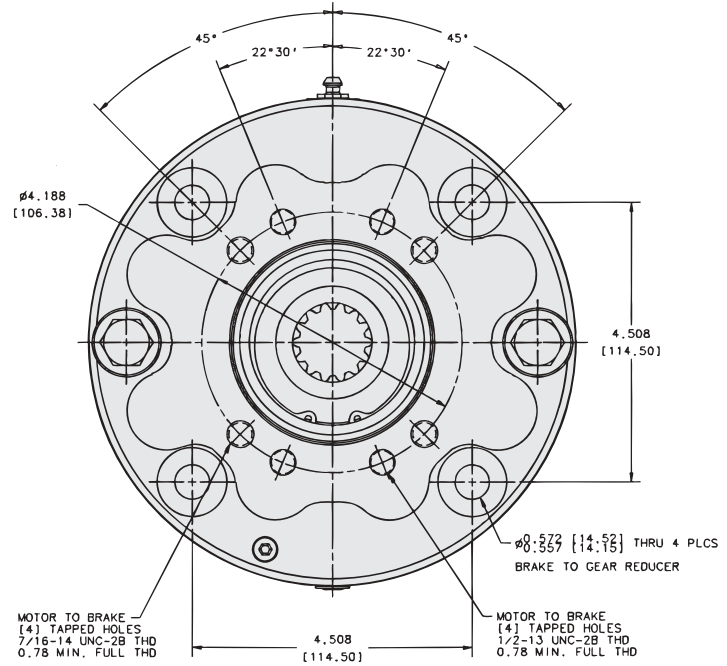
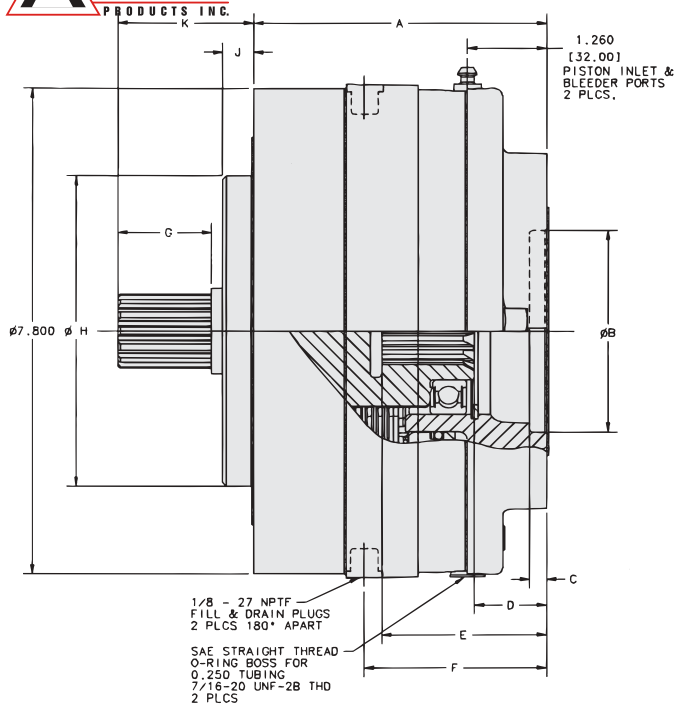

DESCRIPTION	76928	78299
Rated Torque	9100 (1028)	9000 (1017)
Full Release Pressure	240 (17)	230 (16)
Input Spline (Internal)	14T 12/24 ANSI B92.1 Side Fit 30° PA	SAE 6B 1.00 O.D. Parallel Side Fit
Output Spline (External)	14T 12/24 ANSI B92.1 Side Fit 30° PA	14T 12/24 ANSI B92.1 Side Fit 30° PA
A-Mounting Length	4.720 (119.89)	4.720 (119.89)
B-Input Pilot Diameter	3.253 (82.63)	3.253 (82.63)
C-Input Pilot Length	0.270 (6.86)	0.270 (6.86)
D-Input Shaft Clearance	1.156 (29.36)	1.156 (29.36)
E-Max Input Shaft Length	2.660 (67.56)	2.036 (51.71)
F-Fill/Drain Plug Locations	2.930 (74.42)	2.930 (74.42)
G-Min Spline Length	1.500 (38.1)	1.500 (38.1)
H-Output Pilot Diameter	4.999 (126.97)	4.999 (126.97)
J-Output Pilot Length	0.490 (12.45)	0.490 (12.45)
K-Output Shaft Length	2.160 (54.86)	2.160 (54.86)
Oil Fill Volume Horizontal (ml)	150	150
Oil Fill Volume Vertical (ml)	300	300
O-Ring Service Kit	PK-1368	PK-1368
Stack Service Kit	PK-1370	PK-1370
Bearing Service Kit	PK-933	PK-933
Gasket Service Kit	PK-1398	PK-1398

- Units: length/diameter = in (mm), pressure = psi (bar), torque = lbs in (Nm)
- Maximum operating pressure is 3,000 psi. (207 bar).  
Pressure spikes or surges not to exceed 4,000 psi. (278 bar).
- Brake cavity cooling oil pressure not to exceed 15 psi (1 bar).
- Maximum brake speed is 5,000 rpm.